

Couch Biomedical Research Building (4515 McKinley) - 3rd Floor

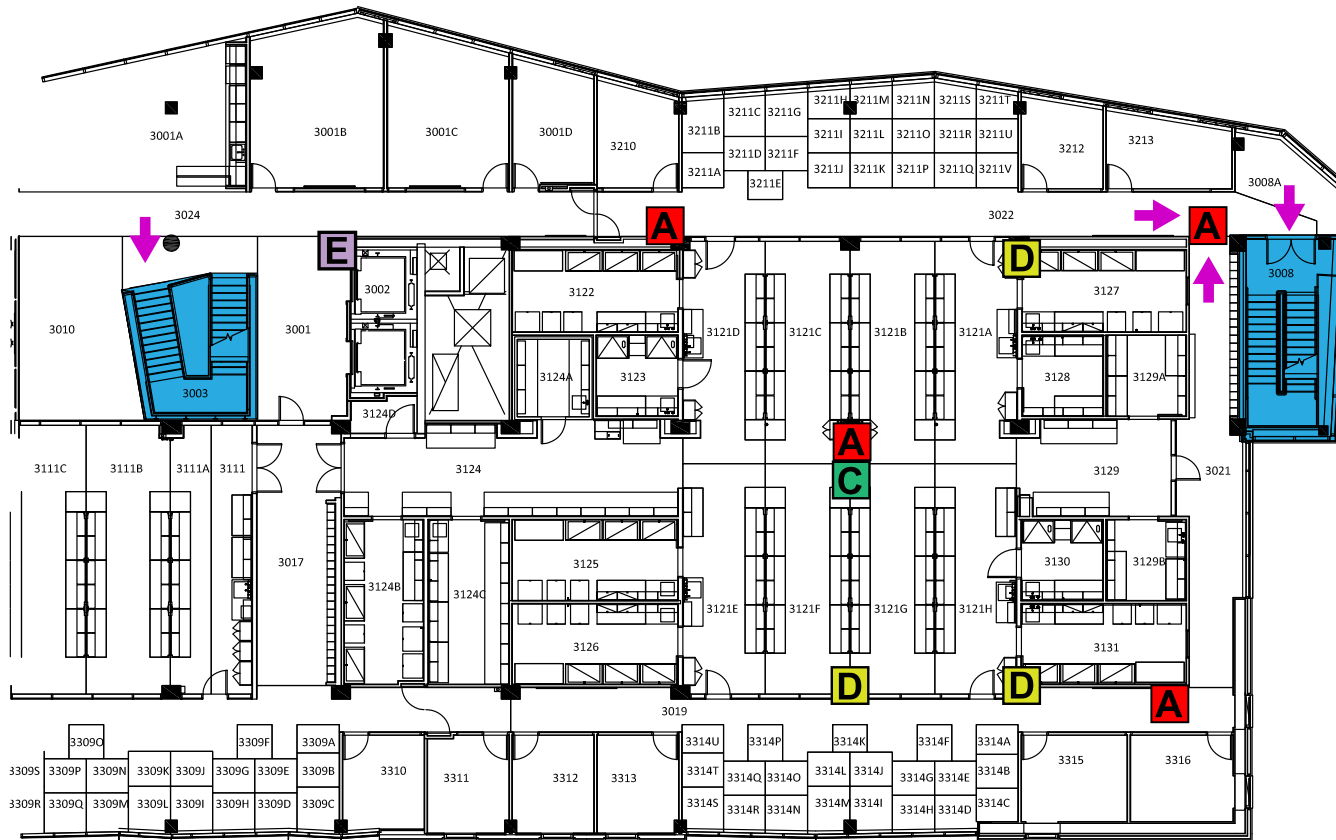

A Fire extinguisher	D Eye wash	Stairway
B Fire pull station	E Defibrillator	F Fire blanket
C Emergency shower	→ Emergency exit paths/points	

In case of fire dial 314-362-4357. Use stairway for exit.
Do not use elevator.

Emergency Assembly Point (EAP):
 Northeast section of of parking lot east of EH&S building